

LED Emergency Edge Lit Exit Sign Combo

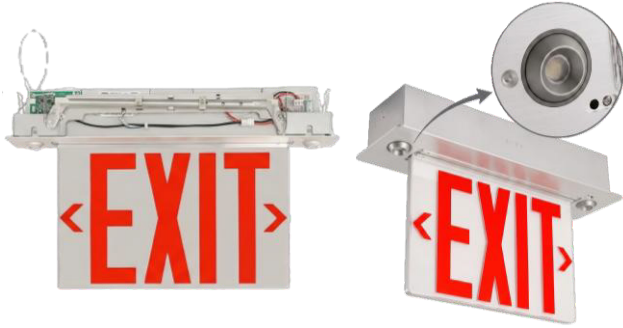

Application: Building exit routes, stairwells, corridors, emergency egress pathways, and other commercial or industrial spaces requiring clear exit identification.

Specifications

Model	VE-EX212-H/HV-A
Input Voltage	120-277 V AC
Power Consumption	<4.5W
Housing Finish	Brushed aluminum
Panel	PMMA (optical-grade acrylic)
Lettering Size	8 inches
Lettering Color	Red
Emergency Operation Time	Min 90 minutes (tri-metallic lithium battery)
Recommended Mounting Height	7.5-10 ft AFF
CRI	≥80
Operating Temperature	32°F~+113°F (0°C~+45°C)
Package Dimensions	23 in x 17 in x 12 in
PC/ Master Pack	4 pcs
Weight	41 LB

Features

- Suitable for universal mounting (recessed or surface) for flexible installation options
- NYC-approved exit sign, equipped with integrated emergency lighting and safety exit indicators
- Energy-efficient LED technology ensures clear and reliable visibility during emergencies
- Integrated dual adjustable LED downlights for enhanced floor lighting
- Delivers a high-end aesthetic at a cost-effective price, ideal for premium venues requiring dependable emergency lighting during short power outages
- Listed for a damp location

Dimensions

Recessed-mounted

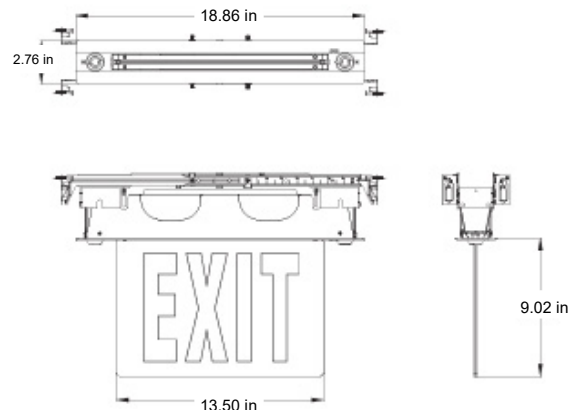
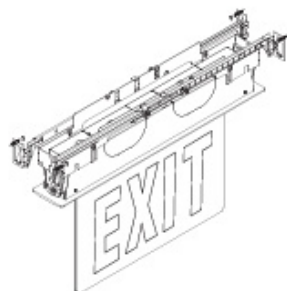

Dimensions

Ceiling-mounted

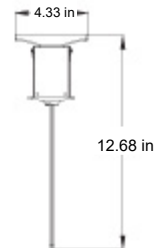
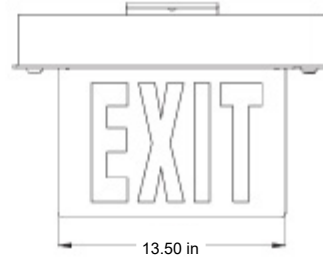
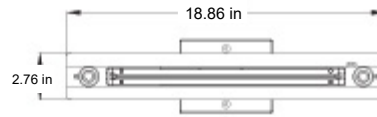
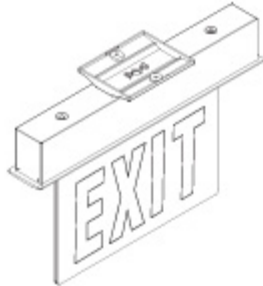

Wall-mounted

