

Round LED Light Engines for Ceiling Flush Mount



Product Features

10W 3" Round Light Engine
 17W 4" Round Light Engine
 23W 5.5" Round Light Engine
 28W 7" Round Light Engine
 40W 8.5" Round Light Engine

80+/90+ CRI

Easy integration into new fixture construction

Integral driver-on-board, 120V AC drive technology

Flicker Rated: <30% for frequencies of 200Hz or below, at 100% and 20% light output. (Title24)

Dimmable to 5% (with ELV/LED dimmers)

UL Listed for use in luminaires

Power Regulation

Operating Temperature: 0°-104°F

L70 life 40,000hours
 5 years limited warranty



Equivalencies 3"	Equivalencies 4"	Equivalencies for 5.5"	Equivalencies for 7.0"	Equivalencies for 8.5"
•1x60W Incandescent •1x18W CFL	•2x40W Incandescent •2x11W CFL •20W T9 Circline	•2x60W Incandescent •2x13W CFL •20W T9 Circline <i>Designed for 11" ceiling mount</i>	•2x75W Incandescent •2x18W CFL •32W T9 Circline <i>Designed for 13" ceiling mount</i>	Designed for highest lumen output applications required



Application

- Ceiling Light
- Flush Mount fixtures

***These engines can be installed in the field directly as a retrofit kit.

Ordering Number Logic

Typical order example: 3RLE27120CDTDH--3" round light engine--2700K--120V--CRI90--Dimmable--Title24--with diffuser and heatsink

Dimension	Version	Wattage	MAX Lumens-Dimmable @CRI80 @2700K	MAX Lumens-Dimmable @CRI80 @3000K	MAX Lumens-Dimmable @CRI90 @2700K	MAX Lumens-Dimmable @CRI90 @3000K	CCT	Voltage	PF	CRI	Control	Title 24	Diffuser & Heatsink
3"	RLE Round Light Engine	10W	750Lm	750Lm	700Lm	700Lm	27 2700K 30 3000K	120V	>0.9	C 90+ Blank 80+	D' Dimmable Blank Non-dimmable	T²	DH'
4"		17W	1200Lm	1200Lm	1100Lm	1100Lm							
5.5"		23W	1700Lm	1700Lm	1500Lm	1600Lm							
7"		28W	2200Lm	2200Lm	2000Lm	2100Lm							
8.5"		40W	3300Lm	3300Lm	3100Lm	3100Lm							

1. Compatible Dimmers: Lutron DV-600P/DVELV-300/SELV-300; Leviton IPL-06.
2. Title24(JA8) flicker free standard qualification.
3. With UL listed diffuser and heatsink.

Light engine line drawings

Unit: inch

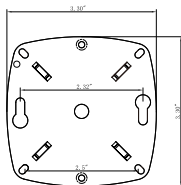

3" Round Light Engine

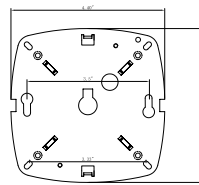
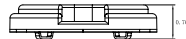

4" Round Light Engine

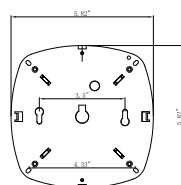

5.5" Round Light Engine

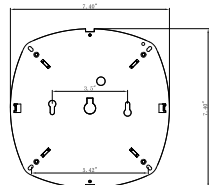

7" Round Light Engine

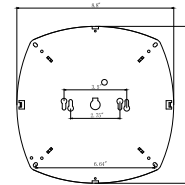

8.5" Round Light Engine

