

# Grow Light Series VGL02



## FEATURES AND BENEFITS

Highest efficacy 2.7  $\mu\text{mol}/\text{J}$

Rack farming system, scientifically and logically layout of the bars, makes excellent heat dissipation and uniform PPFD distribution.

Super slim and lighter weight of the fixture, quick lock design, simple and fast installation supporting daisy chain and 1-10V dimming.



## SPECIFICATIONS

Light Source	LED
Power	640W@277V
Spectrum	FSB
Efficacy	2.7 $\mu\text{mol}/\text{J}$ @277V
Input Voltage	Auto sensing 120-277V/347V/480V
Thermal Management	Passive
Ambient Temperature Range	-4-104°F(-20-40°C)
Dimming	Linearly 1-10V Dimmable
Light Distribution	120°
Lifetime	50,000 hrs
Power Factor	>0.9
Certifications	UL/CUL&CE
Warranty	5 years standard limited
Dimensions&Weight	1156.5x1121x115.5mm(45.53x44.13x4.55in) 14kg/30.8lbs

## NOMINAL AMPERAGE BY AC INPUT VOLTAGE

VOLTAGE	120V	208V	240V	277V	347V
VGL02 640W	5.33A	3.07A	2.66A	2.31A	1.84A

FAMILY	MODEL	SPECTRUM	INPUT VOLTAGE	AC POWER CORD
VGL02	GL02 640W	FSB	120-277V	8.2ft(2.5m)

AC PLUG TYPE	DC EXTENSION CORD	MOUNTING HARDWARE
N5 NEMA 5-15P	8.2ft(2.5m)	Y-fit Hanger
N6 NEMA 6-15P		
N7 NEMA L7-15P		
EU/UK/AU		

## SPECTRUM

Measurements Of Normalized  
Photosynthetic Photon Flux

The specially deployed full spectrum fills the negligence of the main photoreceptors and pigments outside the 660nm and 450nm range, and it is suitable for reproduction to aging in indoor environments. Based on this theory we created the FSB active spectrum which has the balanced wavelength which cover all the growing stages.

Remark :The spectra could be customized for bulk order.

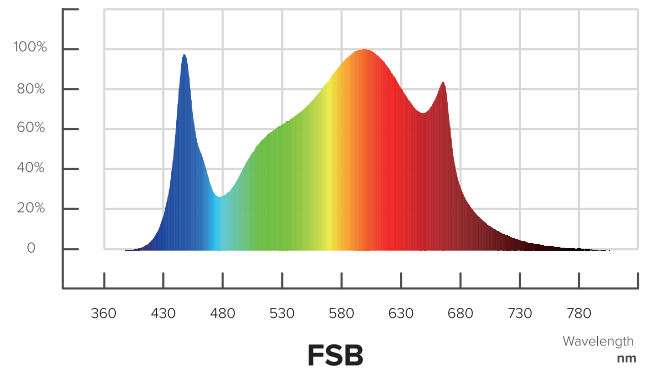

## PPFD VALUE OF DIFFERENT HEIGHT

GL02640W 2.7μmol/J 6"/150mm Height

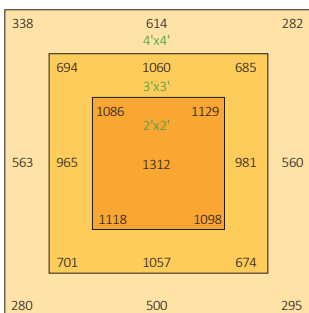

GL02640W 2.7μmol/J 12"/300mm Height

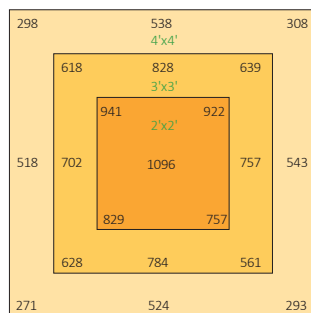

GL02640W 2.7μmol/J 18"/450mm Height

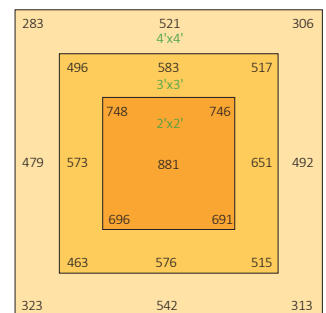

GL02640W 2.7μmol/J 24"/600mm Height

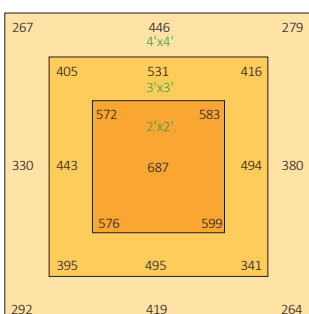

GL02640W 2.7μmol/J 36"/900mm Height

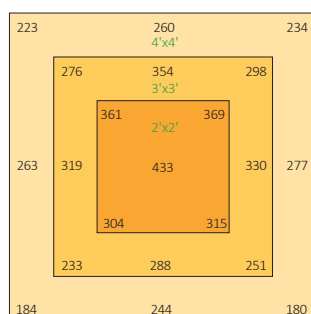

GL02640W 2.7μmol/J 48"/1200mm Height

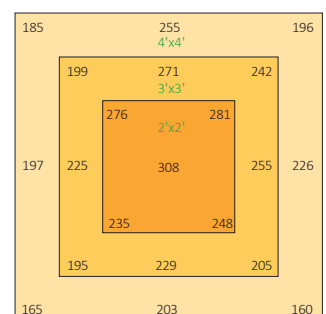

## DIMENSIONS

Unit: mm[in]

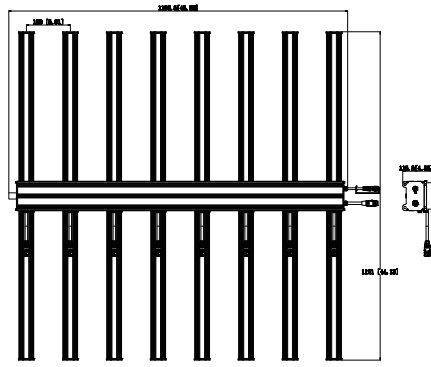

## INSTALLATION GUIDE

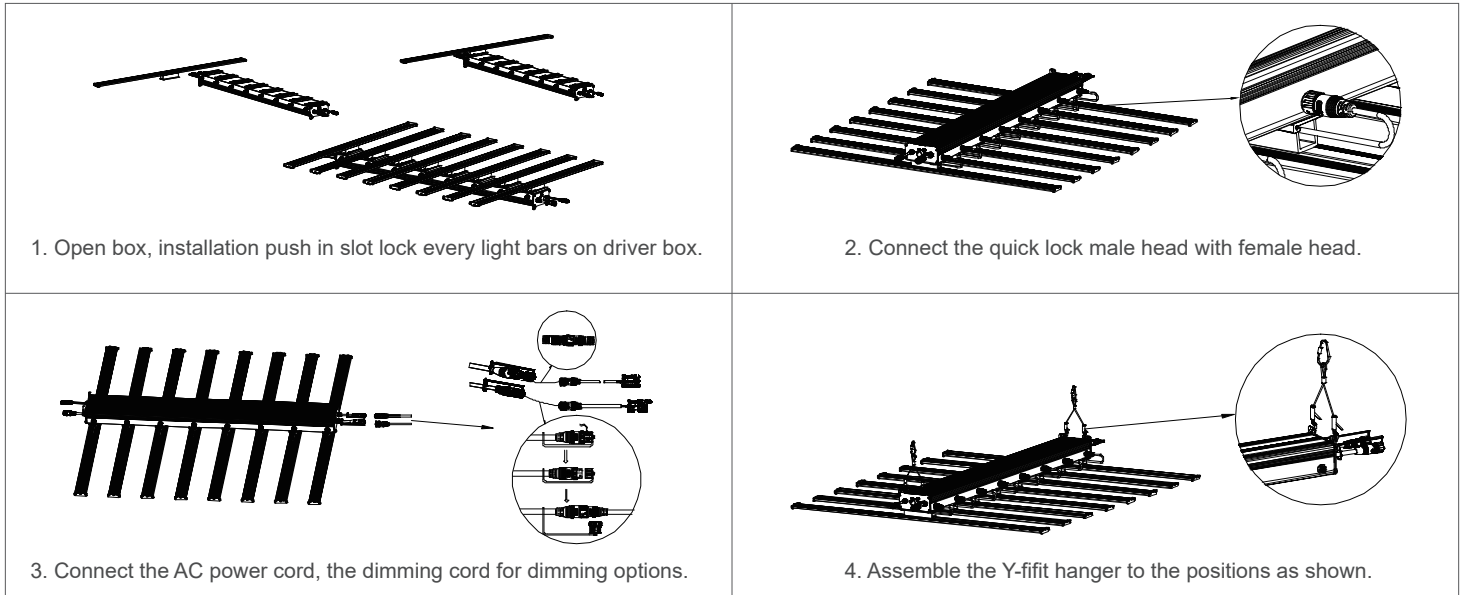

Well packed with EPE foam and fixed with paperboard. Protect the lamp perfectly during the transportation.

