

# CPGL LED Petroleum Canopy Light



ValueEngineeredLighting  
ARCHITECTURAL LIGHTING PRODUCTS



Electrical Information			
Model No.	CPGL-075	CPGL-100	CPGL-120
Power Consumption(±5%)	75W	100W	120W
Power Supply	DONE		
Input Voltage	120-277VAC / 50 / 60 Hz		
Power Factor	>0.9		
Surge Protection	6kV line-line, 10kV line-earth		
Driver Type	Constant Current (CC)		
Dimming	0-10V		

Optic Information			
LED Type	LED 2835		
Luminous Flux (±10%)	11250lm	15000m	18000lm
Efficacy(4000K Ra70)	150lm/w		
Correlated Color Temperature	4000K ( 3000K/5000K optional)		
Color Rendering Index	Ra70 ( Ra80 optional)		
Beam Angle	120*(U00A01)		
UGR level	/		

Dimensions and Mount	
Product Dimension	369.5x368.5x65mm(14.55"x14.51"x2.56")
Luminaire Net Weight	3.9±0.3kg(8.60±0.66Lbs)
Export Carton Size	390x390x90mm(15.35"x15.35"x3.54")
Gross Weight	4.63±0.3kg(8.81±0.66Lbs)
Mounting Option	Surface mount Surface mount with adapter plate G 3/4 conduit mount
Material	ADC12 Tempered Glass
Finish	Powder Coating
Fixture Color	White(RAL9016)
EPA	NA
IK Rating	IK08
IP Rating	IP65
Category of corrosion	C3

Lifespan and Warranty	
Operating Temperature	-30°C to + 50°C(-22°F to+122°F)
Life Time of LED @Ta=25°C	45000hrs-L90 93000hrs-L80 148000hrs-L70
Warranty	5 years

## New Features

The power could be set to 30%, 50%, 75% and 100%.  
The CCT could be set to Cool White, Natural White and Warm White.  
Please select a suitable Power and CCT by the switch.

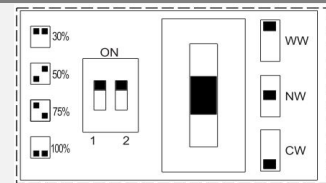

\* Please consult us for details.

## Description

CPGL is a cost-effective petroleum station light with a simple but stylish design. It is designed with a high level of product recognition. The aluminum die-casting heat sink comes with light weight but excellent thermal performance.  
With a built-in dip switch, 3 CCT&4 wattage adjustable is available, which can dramatically help save SKU.

## Key Features

- Full wattage 75W, 100W, 120W
- High light efficacy 150lm/W
- 3 CCT&4 wattage adjustable available
- Multiple installations: surface mount, G 3/4 conduit mount and mount with adapter plate
- IP65&IK08

## Applications

- Gas station
- Underground parking lot
- Warehouse
- Industrial facility
- Exhibition center
- Shopping mall station

• Toll

\* Lumen ouput and light distribution are only for reference. Not all product variations listed on this page are DLC Standard/Premium qualified. Visit [www.designlights.org/search](http://www.designlights.org/search) to confirm qualification.

Photometry

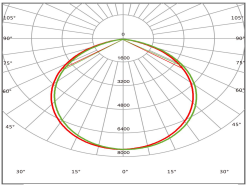

U00A01

Mounting Options

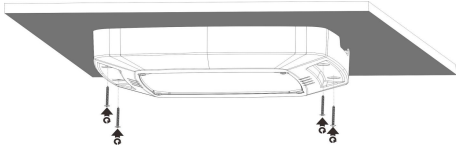

Surface mount

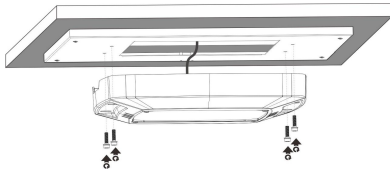

Surface mount with adapter plate

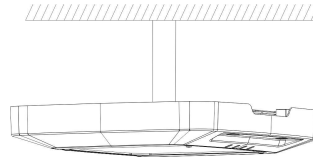

G 3/4 conduit mount

Dimensions

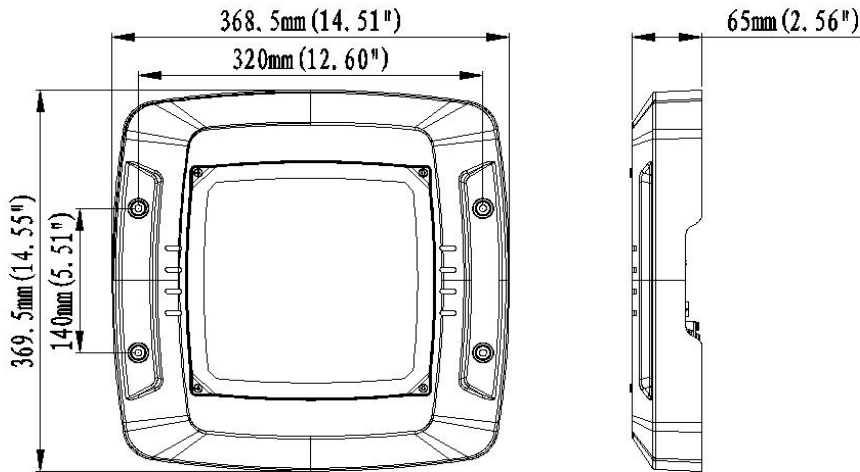

Accessories



**G 3/4 adapter plate**  
 SPCC materials with outdoor powder coating  
 Code:BC-C01-01

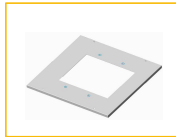

**Ceiling mount adaptor**  
 SPCC materials with outdoor powder coating  
 Code:BC-C01-02



**PIR sensor**  
 Code:ANT-6-4T



**Microwave motion sensor**  
 Code:ANT-5-4T